



## **DENALI Plow Mount MA11720 Honda Talon**

Thank you for purchasing our DENALI plow mount. You now own a premium custom plow mount to allow you to use your plow with your SxS. Please note the following instructions and heed all warnings.

- Your UTV/SxS and/or plow system can cause death or injury, please use caution and common sense when operating your unit.
- Read your Plow Operator Manual, your Winch Operator Manual, and all warning labels before operating your UTV/SxS.
- Operate your UTV/SxS at a walking speed with the blade installed. Do not exceed 5 mph (8 km/h), even with the blade up.
- Do not operate the UTV/SxS on slopes greater than 10 degrees with the plow installed.
- Always lower the plow to the down position before leaving your UTV/SxS unattended.

**SEVERE INJURY OR DEATH MAY RESULT IF YOU ARE NEGLIGENT..**

**MA11720**

**Honda Talon Plow Mount**



**motoalliance**

23001 Industrial Blvd

Rogers, MN 55374

866.527.7637

**Please verify that all hardware and parts are included in your package.**

**Kit Contents:**

Item	Description	QTY
1	MA11720-W1 Main Mount Plate	1
2	MA11720-W2 Front Buckle	1
3	MA11720-W3 Rear Buckle	1
4	MA11720-6 Front Buckle Washer	3
5	3/8"-16 x 1.25" Serrated Flange Bolt	6

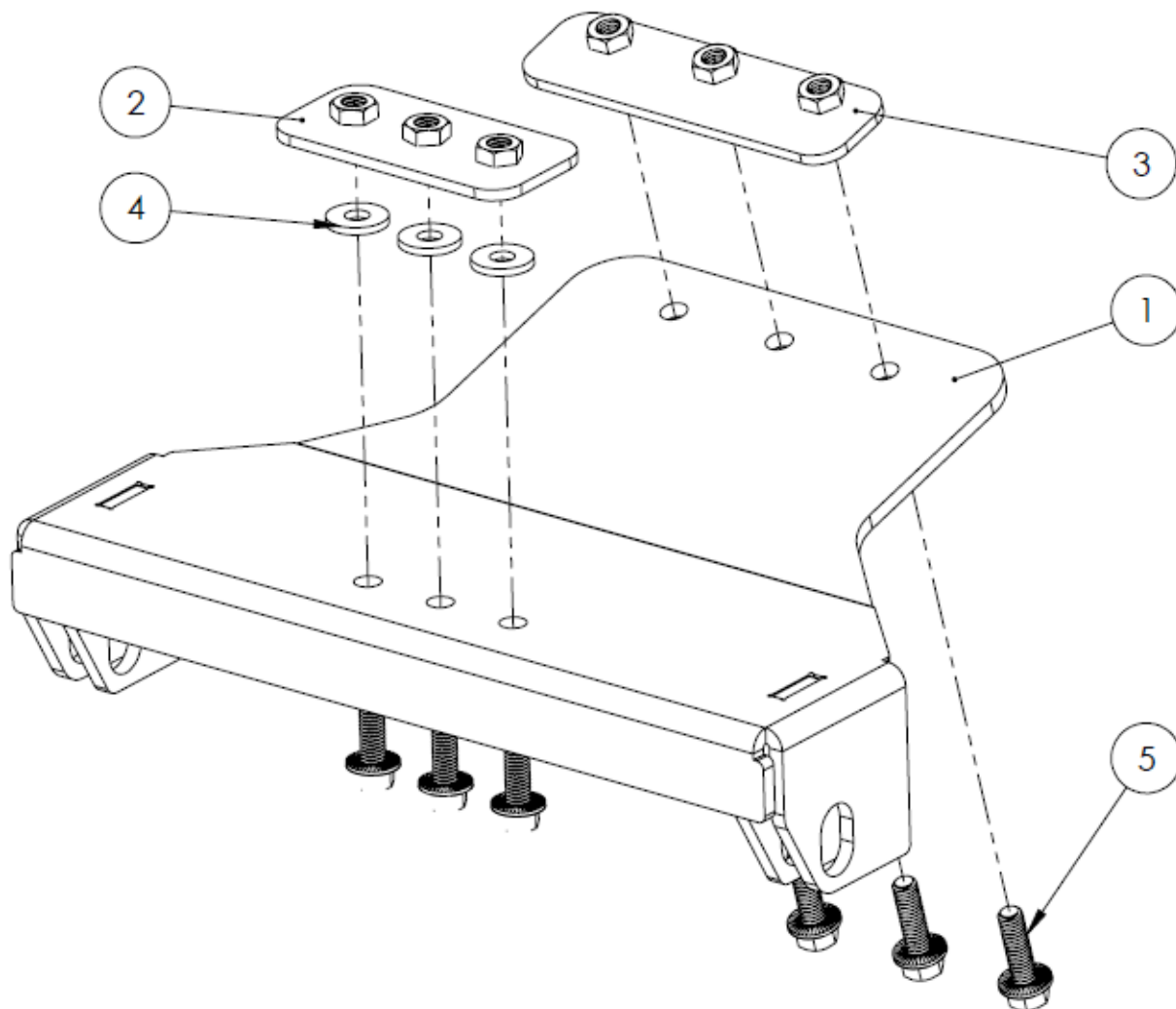
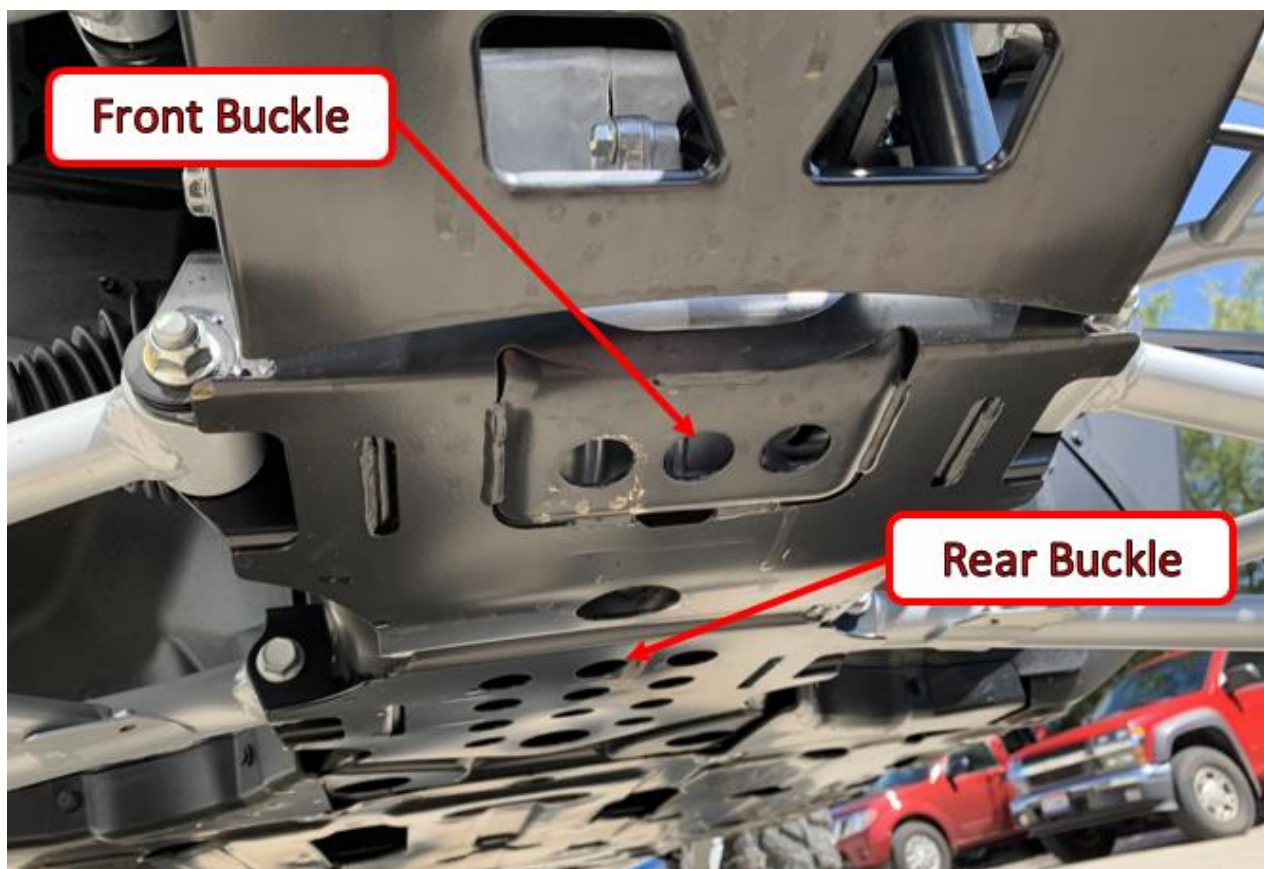

Figure 1



### Honda Talon Installation Instructions

Position the MA11720-W2 Front Buckle and MA11720-W3 Rear Buckle on the topside of the Talon frame as shown in **Figure 2**. Position the weld nuts so they align with the two sets of three holes.



**Figure 2**

1. Hold the MA11720-W1 Plow Mount up to the bottom of the Talon and align the rear three holes with the Rear Buckle Holes. Use three of the supplied 3/8" x 1.25 Serrated Flange Bolts to loosely attach the back of the mount to the frame. Do not tighten at this time.

2. Verify that the weld nuts in the Front Buckle are lined up with the center of the holes in Talon frame as shown in **Figure 3**. This is important because the Front Buckle Washers need to be aligned with Front Buckle, the Talon frame and Main Mount Plate.



**Figure 3**

3. With the mount hanging loosely in place use the three remaining 3/8" bolts and the three Front Buckle Washers to secure the front of the mount plate. **NOTE:** The Front Buckle Washers should fit inside the holes on the machine. It can require a little finesse to get them into place, but it is important for the security of the mount. See **Figure 4**.

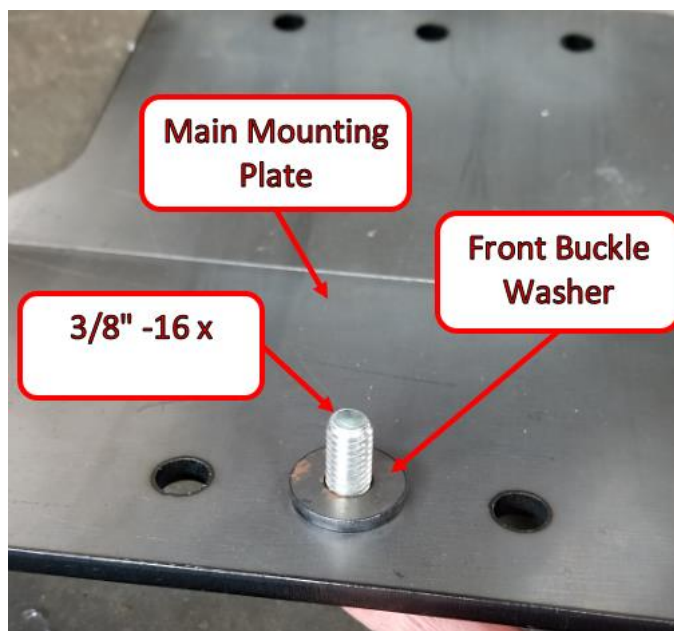

**Figure 4**

**MA11720**

**Honda Talon Plow Mount**



**motoalliance**

23001 Industrial Blvd

Rogers, MN 55374

866.527.7637

4. Make sure the mount is square and flush with the bottom of your machine and tighten all hardware.

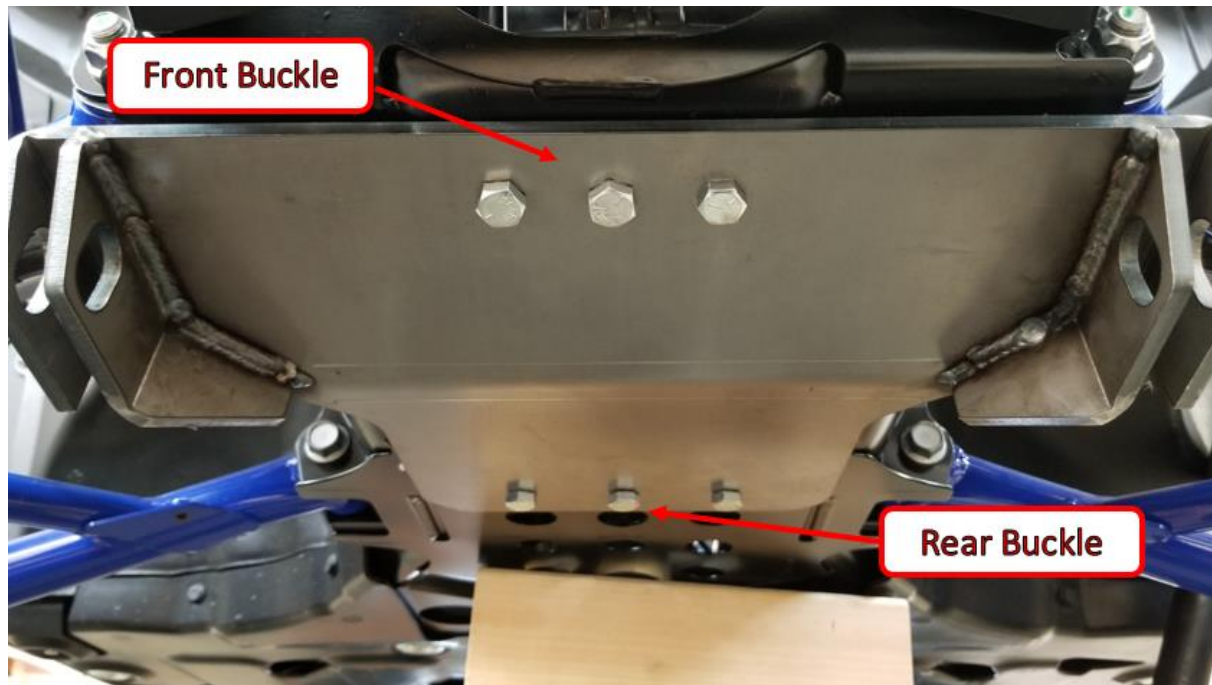

**Figure 5**

5. Attach the plow system to the plow mount per the manufacturer's instructions.
6. After the first few rides, verify that all hardware is secure as it can move around initially.